



# Instruction Manual

## Compact Bag-In-Box Oil

Model No. 2257C, 2257CX



**GOLD MEDAL® PRODUCTS CO.**

10700 Medallion Drive, Cincinnati, Ohio 45241-4807 USA



# Table of Contents

.....	1
<b>SAFETY PRECAUTIONS .....</b>	<b>3</b>
<b>INSTALLATION INSTRUCTIONS .....</b>	<b>5</b>
Inspection of Shipment .....	5
Manual.....	5
Model Description .....	5
Setup.....	5
Electrical Requirements .....	5
Before You Plug In Machine .....	6
Unit Installation.....	6
Oil Installation.....	7
Steps to Attach the Universal Bag Connector.....	7
<b>OPERATING INSTRUCTIONS .....</b>	<b>8</b>
Controls and Their Functions.....	8
Operating the Oil Dispense Unit.....	8
<b>Program the E-Z Set Timer.....</b>	<b>9</b>
<b>Care and Cleaning .....</b>	<b>10</b>
Exterior Surface Cleaning.....	10
Sanitizing the Tubing and Pump.....	10
<b>Troubleshooting.....</b>	<b>12</b>
<b>MAINTENANCE INSTRUCTIONS .....</b>	<b>13</b>
<b>ORDERING SPARE PARTS.....</b>	<b>14</b>
Cabinet Exterior – Parts Breakdown.....	15
Tubing and Connectors – Parts Breakdown .....	16
Control Box Interior .....	17
<b>Wiring Diagram .....</b>	<b>18</b>
<b>WARRANTY.....</b>	<b>20</b>

# SAFETY PRECAUTIONS

	<b>⚠ DANGER</b>
	<p>Machine must be properly grounded to prevent electrical shock to personnel. Failure to do so could result in serious injury, or death. DO NOT immerse any part of this equipment in water. DO NOT use excessive water when cleaning. Keep cord and plug off the ground and away from moisture. Always unplug the equipment before cleaning or servicing. Make sure all machine switches are in the OFF position before plugging the equipment into the receptacle.</p> <p>008_051514</p>



	<b>⚠ DANGER</b>
	<p>Improper installation, adjustment, alteration, service, or maintenance can cause property damage, injury, or death. Any alterations to this equipment will void the warranty and may cause a dangerous condition. This appliance is not intended to be operated by means of an external timer or separate remote-control system. NEVER make alterations to this equipment. Read the Installation, Operating, and Maintenance Instructions thoroughly before installing, servicing, or operating this equipment.</p> <p>014_020416</p>

	<b>⚠ WARNING</b>
	<p>To avoid burns, DO NOT touch heated surfaces. DO NOT place or leave objects in contact with heated surfaces.</p> <p>009_092414</p>

	<b>⚠ WARNING</b>
	<p>ALWAYS wear safety glasses when servicing this equipment.</p> <p>010_010914</p>

	<b>⚠ WARNING</b>
	<p>No user serviceable parts inside. Refer servicing to qualified service personnel.</p> <p>011_051514</p>

	<b>⚠ WARNING</b>
	<p>Read and understand operator's manual and all other safety instructions before using this equipment. To order copies of the operator's manual go to <a href="http://gmpopcorn.com">gmpopcorn.com</a> or write to Gold Medal Products Co., 10700 Medallion Drive, Cincinnati, OH 45241 USA 1-(800)-543-0862</p> <p>022_060215</p>

	 <b>WARNING</b>
	DO NOT allow direct contact of this equipment by the public when used in food service locations. Only personnel trained and experienced in the equipment operation may operate this equipment. Carefully read all instructions before operation. <span style="float: right;">012_010914</span>

	 <b>WARNING</b>
	This machine is NOT to be operated by minors. <span style="float: right;">007_010914</span>

This appliance is not intended for use by persons (including children) with reduced physical, sensory or mental capabilities, or lack of experience and knowledge, unless they have been given supervision or instruction concerning use of the appliance by a person responsible for their safety.

**Note:** Improvements are always being made to Gold Medal's equipment. This information may not be the latest available for your purposes. It is critical that you call Gold Medal's Technical Service Department at 1-800-543-0862 for any questions about your machine operations, replacement parts, or any service questions. (Gold Medal Products Co. does not assume any liability for injury due to careless handling and/or reckless operation of this equipment.) General images may be used in manual for reference only.

# INSTALLATION INSTRUCTIONS

## Inspection of Shipment

After unpacking, check thoroughly for any damage which may have occurred in transit. Claims should be filed immediately with the transportation company. The warranty does not cover damage that occurs in transit, or damage caused by abuse, or consequential damage due to the operation of this machine, since it is beyond our control (reference warranty in back of manual).

## Manual

Read and understand the operator's manual and all other safety instructions before using this equipment. To order copies of the operator's manual go to [gmpopcorn.com](http://gmpopcorn.com) or write to Gold Medal Products Co., 10700 Medallion Drive, Cincinnati, OH 45241 USA 1-(800)-543-0862.

## Model Description

The Compact Bag-In-Box is a pump unit only, designed to sit on a box of oil in a cabinet or on a counter. The unit does NOT have a rack assembly, heater/blower, or heated line capability. The compact unit is designed for use with liquid oil only.

**2257C:** Compact B.I.B. Unit features a Teach Timer (1 timer setting).

**2257CX:** Export Compact B.I.B. Unit features a Teach Timer (1 timer setting).

## Setup



The B.I.B. Oil Dispenser is fully assembled and was tested at the factory. Remove all packaging and tape prior to installation.

## Electrical Requirements

The following power supply for the oil dispense unit is provided by the popper:

**2257C:** 120 V~, 45 Watts, 60 Hz.

**2257CX:** 230 V~, 45 Watts, 50 Hz.

	 <b>DANGER</b>
	<p>Machine must be properly grounded to prevent electrical shock to personnel. Failure to do so could result in serious injury, or death. DO NOT immerse any part of this equipment in water. DO NOT use excessive water when cleaning. Keep cord and plug off the ground and away from moisture. Always unplug the equipment before cleaning or servicing. Make sure all machine switches are in the OFF position before plugging the equipment into the receptacle.</p> <p>008_051514</p>

This machine is intended to be used with a Gold Medal popcorn popper. The popcorn machine will have a proper power cord to connect to the pump.

A certified electrician must furnish sufficient power for proper machine operation. We recommend the popper powering this unit be on a dedicated and protected circuit. Failure to wire properly will void the warranty and may result in damage to the machine. It is Gold Medal Products Co.'s recommendation that the machine powering this pump be plugged directly into a wall outlet. The use of extension cords is not recommended due to safety concerns, and may cause sacrificed and/or reduced performance. Make sure cord is located to prevent a trip hazard or unit upset.

## Before You Plug In Machine

1. Make sure all machine switches on the popper are OFF before plugging the equipment into the popper.
2. Make sure the popcorn machine can accept the grounded plugs (where applicable) on the power supply cord.
3. The wall outlet for the popcorn machine must have the proper polarity. If in doubt, have a competent electrician inspect the outlet and correct if necessary.
4. **DO NOT** use a grounded to un-grounded receptacle adapter on the popper (where applicable).
5. Install the unit in a level position.

## Unit Installation

Follow the instructions below to install the oil dispense unit:

1. Place unit on a box of oil in a cabinet or on a counter near the popper unit with the pump facing the operator.
2. Connect the pump's discharge oil line (tube without the Universal Bag Connector) to the metal oil line on the popper using the hose clamp provided.
3. Plug the power cord socket (from the popcorn machine) into the 6 prong plug located on the side of the pump's control box.
4. The unit is ready to connect to the box of oil (reference Oil Installation section).

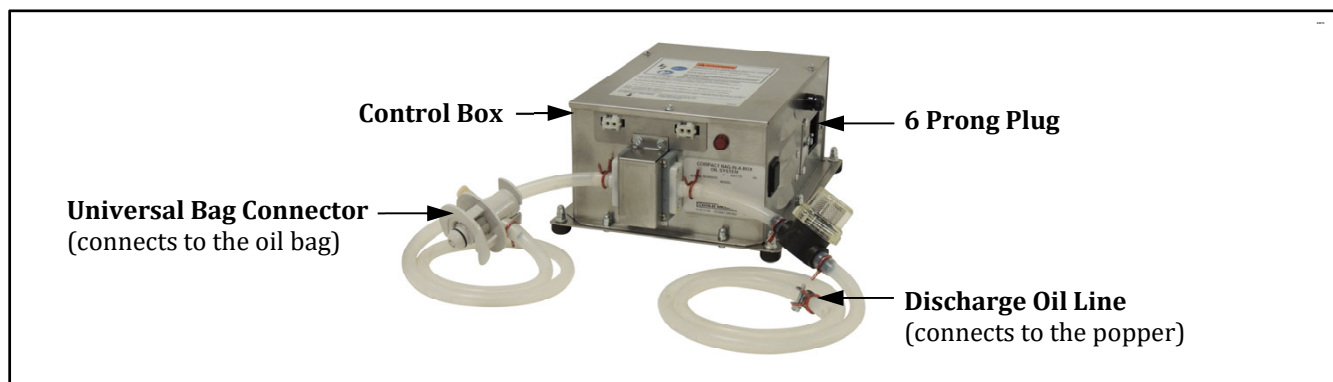



## Oil Installation

The unit is designed to be used with liquid oil only; it is not for use with coconut oil.

**IMPORTANT:** DO NOT attempt to operate this system with a bag which has been removed from the box. This unit is not intended for use with volatile food products (i.e. real butter).

1. Set the box so the oil bag nozzle is located towards the bottom of the box to permit a free flow of the oil from the bag.
2. Remove the cardboard cutout on the box to expose the bag nozzle, and then remove the cap from the bag nozzle.
3. Attach the Universal Bag Connector from the oil dispense unit to the bag nozzle (reference images below for Steps to Attach the Universal Bag Connector).
4. Once oil is connected, the unit is ready to be programmed for the oil dispense volume delivered to the popper (reference Program the EZ Set Timer section).

### Steps to Attach the Universal Bag Connector



Bag Nozzle

Universal Bag Connector

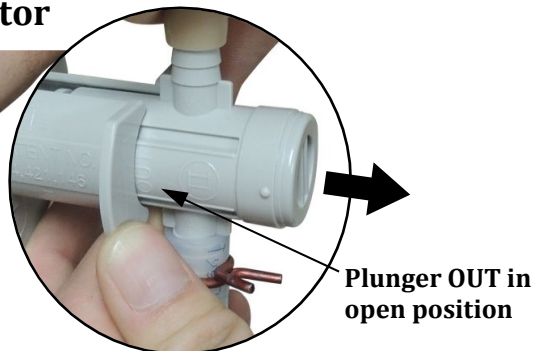
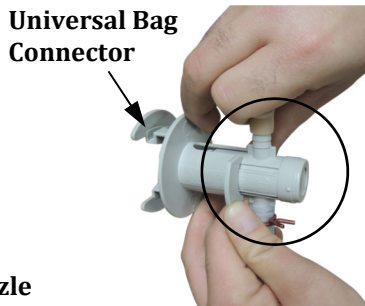

Plunger OUT in open position

**Step 1:** Pull the Universal Bag Connector's plunger out until it clicks into the open position.



**Step 2:** Grasp the Bag Nozzle and slide the Bag Connector on from the side.



**Step 3:** With the hose connector in place, press plunger forward to lock.



**Step 4:** Connector shown with plunger fully forward in lock position.

# OPERATING INSTRUCTIONS

## Controls and Their Functions

This unit is controlled using the Oil System Master Switch (powers the dispenser), and the Oil Dispense Switch (dispenses oil) located on the control panel of the popper. (Reference the Controls section in the Popper's Manual.)

### RED PILOT LIGHT

Pilot Light is located on the control box of the oil unit. When lit, the red light indicates there is power to the oil dispense unit (with popper Oil Master Switch ON).

### 1 AMP FUSE

The 1 AMP Fuse protects the oil dispense unit from an overload condition.

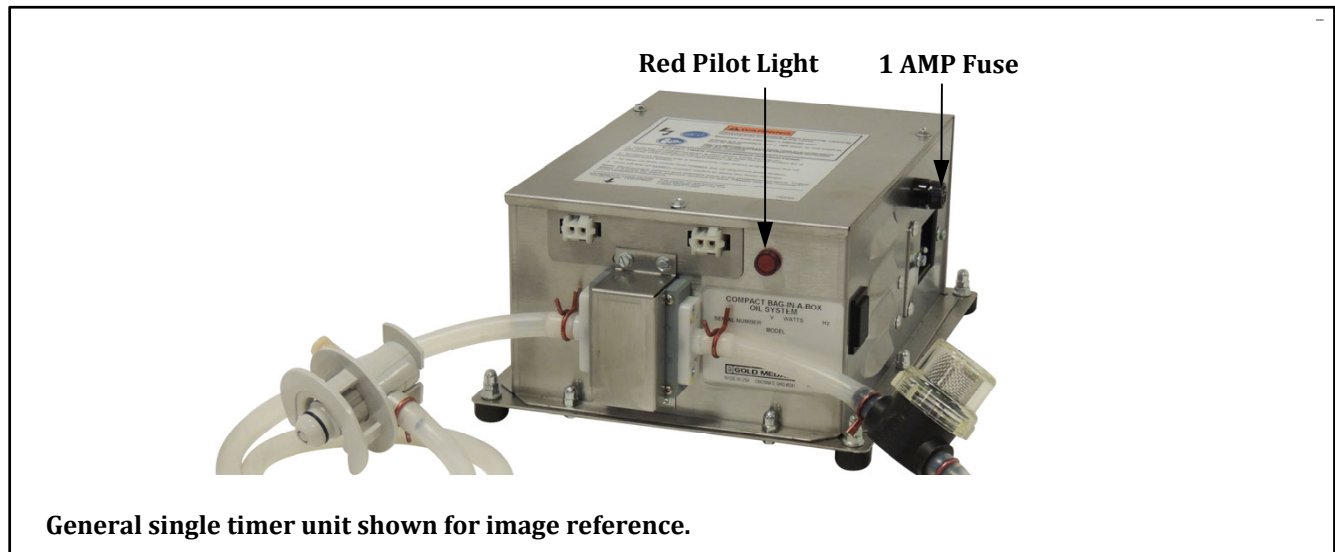

## Operating the Oil Dispense Unit

1. Turn Oil System Master Switch ON (switch located on Control Panel of the Popper) to provide power to the oil dispense unit.
2. The pump dispenses the programmed amount of oil when the Oil Dispense Switch (located on the popper control panel) is pressed. See Program the E-Z Set Timer section of this manual to set or adjust the oil dispense volume.



## Program the E-Z Set Timer

Follow the steps below to program the timer to dispense the oil amount needed to pop a batch of popcorn. It is recommended to set the oil volume to approx. 30% of the raw popcorn charge used.

To program, use the Oil Dispense Switch and the Oil System Master Switch located on the control panel of the popper.

**Note:** Take volume measurements from oil delivery tube located in popper above the kettle. Allow kettle to cool completely prior to taking volume measurements.

### Priming the Unit:

1. Turn Oil System Master Switch ON.
2. Hold a cup under the oil delivery tube in popper, **PUSH and RELEASE** the Oil Dispense Switch to START dispensing oil.
3. As soon as oil flows steady, turn Oil System Master Switch OFF; unit is now primed. Wait 30 seconds to allow oil to settle/drain before programming.

### Programming the Unit:

4. Hold down Oil Dispense Switch and turn Oil System Master Switch ON, **continue to hold Oil Switch for 5 seconds** until the indicator light (OIL Light or LOAD/DUMP Light) on popper starts to blink ON-OFF, then release switch; unit now in program mode.
5. Hold a measuring cup under the oil delivery tube in popper; **PUSH and RELEASE** the Oil Dispense Switch to START oil flow.
6. When correct amount of oil has been dispensed, **PUSH and RELEASE** Oil Dispense Switch again to STOP oil flow. The Oil Switch may be pushed ON/OFF as many times as needed to finalize ("top off") the oil amount.
7. Turn Oil System Master Switch OFF, then back ON to **SAVE the setting**. Unit will now dispense the "programmed" amount of oil when the Oil Dispense Switch is pushed. The Oil Light on the popper will light continuously when oil pump is dispensing.
8. Wait 30 seconds to allow oil to settle/drain, then re-check the oil quantity.

**Dual Timer Note:** Units with two oil timer settings available must be set for Flexi-Pop, if available on the unit (Flexi-Pop option not available on Cornado units). Otherwise, the two settings must be used for Salt/Sweet. Select one corn amount and program the first timer; then select the other corn amount and program the second timer. (Pumps with a single timer will only remember the last setting programmed.)

**Manual Mode** (Oil only dispenses when the Oil Dispense Switch is held IN):

OPTIONAL - Use to manually dispense oil, or for cleaning. Follow Step 4 then skip to Step 6.

**To use a timer setting after using Manual Mode, the unit MUST be reprogrammed.**

## Care and Cleaning

	<b>⚠ DANGER</b>
	Machine must be properly grounded to prevent electrical shock to personnel. <b>DO NOT immerse in water.</b> DO NOT clean appliance with a water jet. Always unplug the equipment before cleaning or servicing. <small>025_111616</small>

	<b>⚠ WARNING</b>
	To avoid burns, DO NOT touch heated surfaces. DO NOT place or leave objects in contact with heated surfaces. <small>009_092414</small>

Good sanitation practice demands that all food preparation equipment be cleaned regularly (only use non-toxic, food grade cleaners). A clean looking, well-kept machine is one of the best ways of advertising your product.

Follow the directions below to clean and sanitize the unit.

### Exterior Surface Cleaning

1. With the machine OFF, unplug the unit and allow it to cool before attempting to clean.
2. The exterior surfaces can be cleaned by wiping oil spills with a dry towel, then wiping with another towel dampened with mild soap and warm water.
3. Wipe stainless steel parts with a clean cloth and cleaner designed for stainless steel, such as Gold Medal Watchdog Stainless Cleaner (Item No. 2088).

**DO NOT** use oven cleaners or abrasive materials as they will damage parts of machine.

### Sanitizing the Tubing and Pump

Items Needed: **(2) Empty Pails** (5 gallon buckets)

**(1) 6-Ft Piece of 5/16" ID Tubing and Clamp** (Item No. 102187 and 41163)

**(1) Cleaning Bracket** (Item No. 12594)

**Gold Medal Chlor-Tech Sanitizer** (Item No. 1109)

**Measure Cup** (for priming unit)

1. Make sure BIB and popper kettle have cooled completely before attempting to clean.
2. Fill a clean, empty pail half-full with hot water and Gold Medal Chlor-Tech Sanitizer (reference instructions on sanitizer container for appropriate amount).
3. Disconnect Universal Bag Connector from oil bag, and connect it to cleaning bracket as shown on next page. **Make sure the quick disconnect is engaged.**

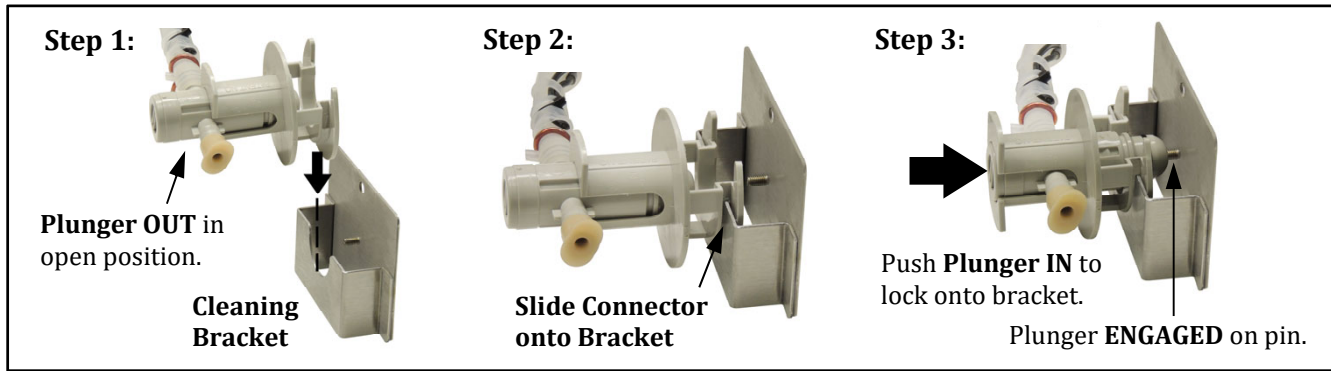

4. Place hose with cleaning bracket into the pail of sanitizing solution.
5. Attach the 6-ft piece of tubing to oil dispense tube above popper kettle (see image below).

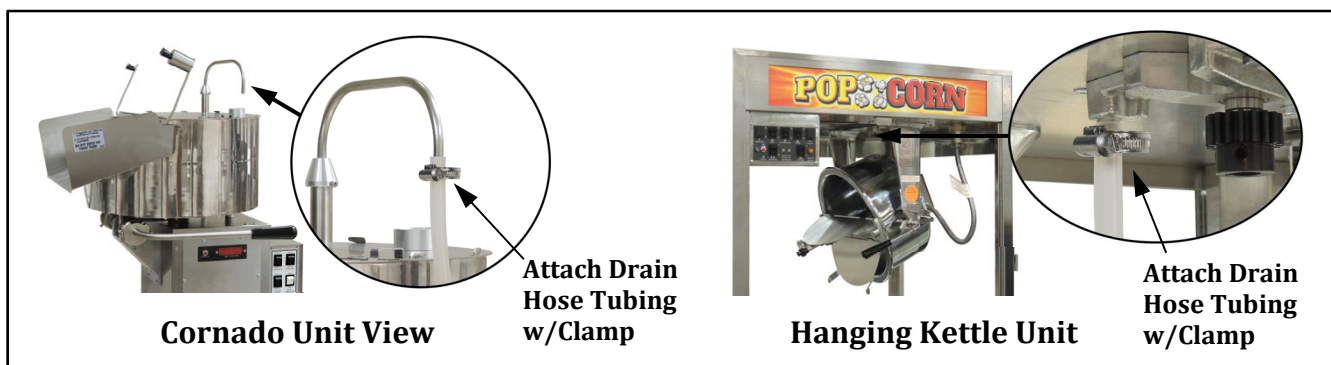

6. Place other end of drain hose in empty pail.
7. Use the Oil Dispense Switch (located on the control panel of the popper), to dispense solution until tubes are clean and free of oil.
8. When pumping is complete, discard dirty solution, clean the pail, and refill with clean hot water.
9. Remove hose with bracket from solution pail and place it in the hot water.
10. Switch drain hose to solution pail.
11. Use the Oil Dispense Switch to dispense hot water until tubes are clean and free of sanitizer.
12. When cleansing is complete, remove drain hose from oil dispense tube above kettle.
13. Remove hose with bracket from hot water, disconnect bracket, and wipe hose and bag connector dry.
14. Reconnect BIB to bag of oil.
15. Purge and prime the system – hold a measuring cup (or medium sized container) under dispenser spout; press the Oil Dispense Switch to dispense oil until all water has been expelled and tubes are primed with oil. After cleaning, always discard the oil dispensed in priming.
16. Sanitize cleaning items for next use.



# Troubleshooting

General unit troubleshooting issues are listed below, also reference the Troubleshooting section in the popper manual.

Issue	Possible Cause	Solution
<p><b>Oil Pump Does Not Deliver Oil to Kettle</b></p>	<p>A. Oil System Master Switch</p> <p>B. Pump is not operating</p> <p>C. Mini Circuit Breaker(s) on popper tripped (if equipped)</p> <p>D. Pump Fuse</p> <p>E. Pump is operating, but oil is not dispensed.</p> <p>F. Programmable Timer</p>	<p>A. Check to make sure the Oil System Master Switch is ON.</p> <p>B. Check to make sure the power cord from the popper is FIRMLY plugged into the oil dispense unit. If unit is plugged in, but not operating, the pump may need to be replaced. Check with qualified service personnel.</p> <p>C. Check the Mini Circuit Breaker(s) on the popper; if reset, then trips again, the unit must be inspected/repared by qualified service personnel.</p> <p>D. Check the 1 AMP Fuse located on the Control Box of the oil dispense unit; replace if needed. (For NO TIMER units only - the Oil Light on the control panel of the popper will NOT light up if the oil dispense fuse is blown). If replaced and blows again, have a qualified service person inspect/repair the unit.</p> <p>E. Check that the oil has not solidified in the lines. This unit is for use with liquid oil only (DO NOT use with coconut oil). Check for air leaks into the oil line; be sure the filter in the line is not loose.</p> <p>F. If oil is only dispensed while the Oil Dispense Switch is pushed, unit may be in Manual Mode. See Program the EZ-Set Timer section to reprogram the timer.</p> <p>If wrong oil amount is dispensed, timer needs to be reprogrammed to correct amount.</p> <p>If timer still dispenses incorrect amount, timer may need to be replaced, have a qualified service person inspect/replace control board.</p>



# MAINTENANCE INSTRUCTIONS

	<b>⚠ DANGER</b>
	<p>Machine must be properly grounded to prevent electrical shock to personnel. Failure to do so could result in serious injury, or death. DO NOT immerse any part of this equipment in water. DO NOT use excessive water when cleaning. Keep cord and plug off the ground and away from moisture. Always unplug the equipment before cleaning or servicing. Make sure all machine switches are in the OFF position before plugging the equipment into the receptacle.</p> <p>008_051514</p>

	<b>⚠ DANGER</b>
	<p>Improper installation, adjustment, alteration, service, or maintenance can cause property damage, injury, or death. Any alterations to this equipment will void the warranty and may cause a dangerous condition. This appliance is not intended to be operated by means of an external timer or separate remote-control system. NEVER make alterations to this equipment. Read the Installation, Operating, and Maintenance Instructions thoroughly before installing, servicing, or operating this equipment.</p> <p>014_020416</p>

	<b>⚠ WARNING</b>
	<p>No user serviceable parts inside. Refer servicing to qualified service personnel.</p> <p>011_051514</p>

	<b>⚠ CAUTION</b>
	<p>THE FOLLOWING SECTIONS OF THIS MANUAL ARE INTENDED ONLY FOR QUALIFIED SERVICE PERSONNEL WHO ARE FAMILIAR WITH ELECTRICAL EQUIPMENT. THESE ARE NOT INTENDED FOR THE OPERATOR.</p> <p>027_010914</p>



---

## ORDERING SPARE PARTS

1. Identify the needed part by checking it against the photos, illustrations, and/or parts list. (General images may be used in manual for reference only.)
2. Use only approved replacement parts when servicing this unit.
3. When ordering, please include part number, part name, and quantity needed.
4. Please include your model number, serial number, and date of manufacture (located on the machine nameplate/data plate) with your order.
5. Address all parts orders to:

Parts Department  
Gold Medal Products Co.  
10700 Medallion Drive  
Cincinnati, Ohio 45241-4807

Or, place orders by phone or online:

Phone: (800) 543-0862  
(513) 769-7676  
Fax: (800) 542-1496  
(513) 769-8500  
E-mail: [info@gmpopcorn.com](mailto:info@gmpopcorn.com)  
Web Page: [gmpopcorn.com](http://gmpopcorn.com)

## Cabinet Exterior – Parts Breakdown

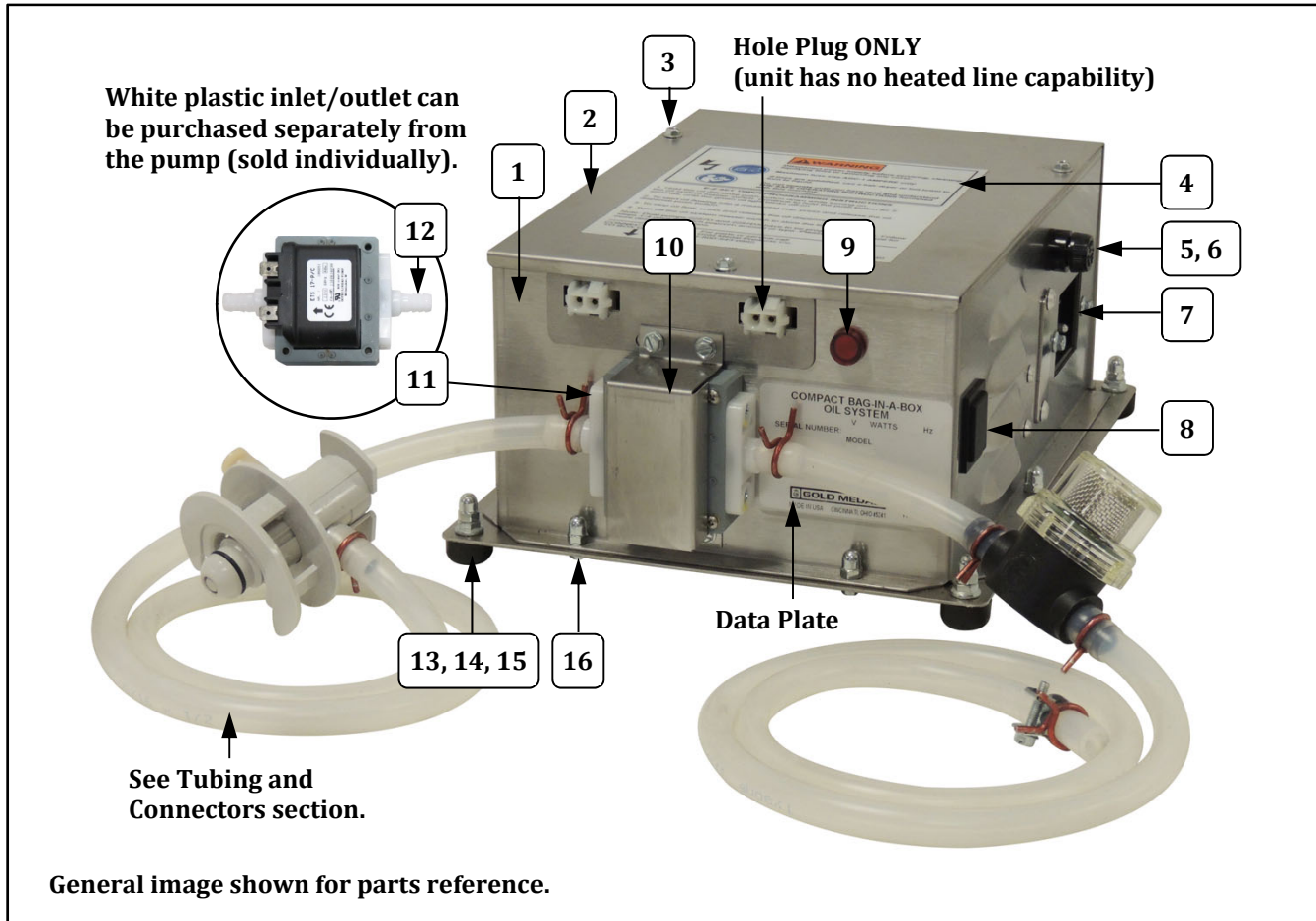

Item	Part Description	Part Number	
		2257C	2257CX
1	CONTROL BOX	39148	39148
2	CONTROL BOX COVER	79377	79377
3	8-32 X 3/8 SLT. HWH M/S	42044	42044
4	2257 LABEL	79440	79440
5	FUSE HOLDER	74636	74636
6	1 AMP FUSE (located inside Fuse Holder)	79341	79341
7	JONES PLUG ASSEMBLY (6 Position)	67900	67900
8	ROCKER SWITCH HOLE PLUG	42743	42743
9	PILOT LIGHT - RED	41033	41032
10	PUMP COVER	79423	79423
11	B.I.B. OIL PUMP	79282	79282EX
12	BARBED PUMP INLET/OUTLET (Barbed white plastic piece ONLY - sold individually)	79282A	79282A
13	RUBBER BUMPER/FOOT	87247	87247
14	8-32 SERRATED FLANGE NUT	61151	61151
15	ACORN NUT #8-32	47702	47702
16	8-32 X 1/4 HX HD WHIZLOCK	42045	42045

## Tubing and Connectors – Parts Breakdown

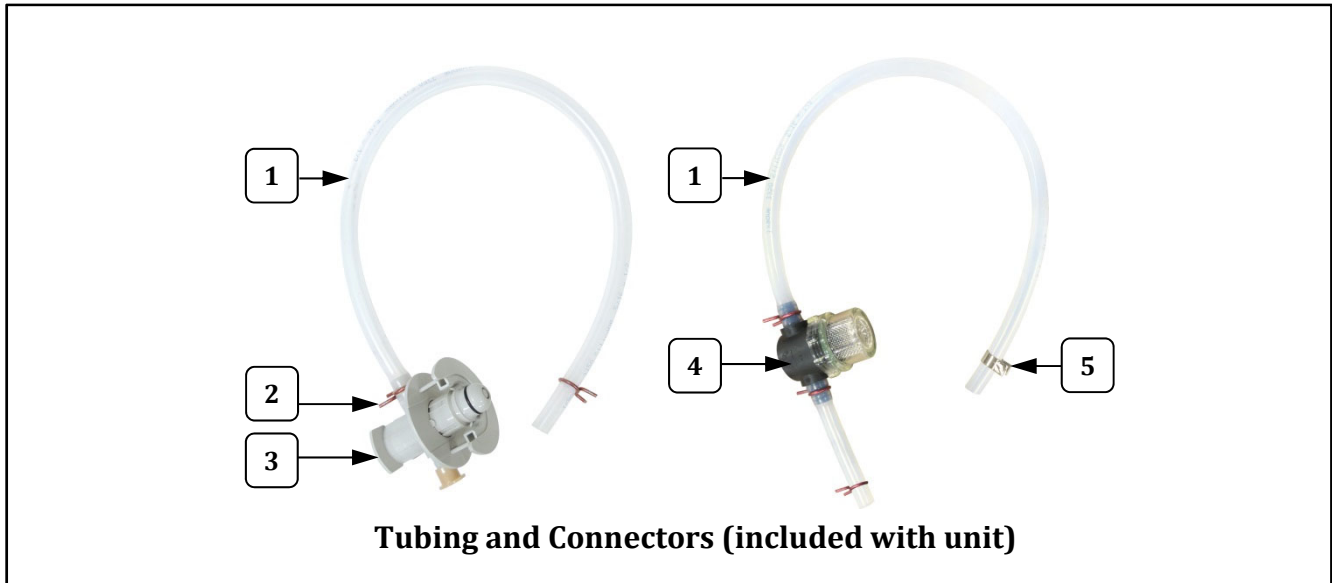

Item	Part Description	Part Number
		All Models
1	FOOD TUBING (replacement tubing is sold by the foot)	91375
2	SINGLE WIRE HOSE CLAMP	75110
3	UNIVERSAL BAG CONNECTOR	79100G
4	IN-LINE STRAINER	79269
5	7/16" - 1/2" HOSE CLAMP	67843

## Control Box Interior

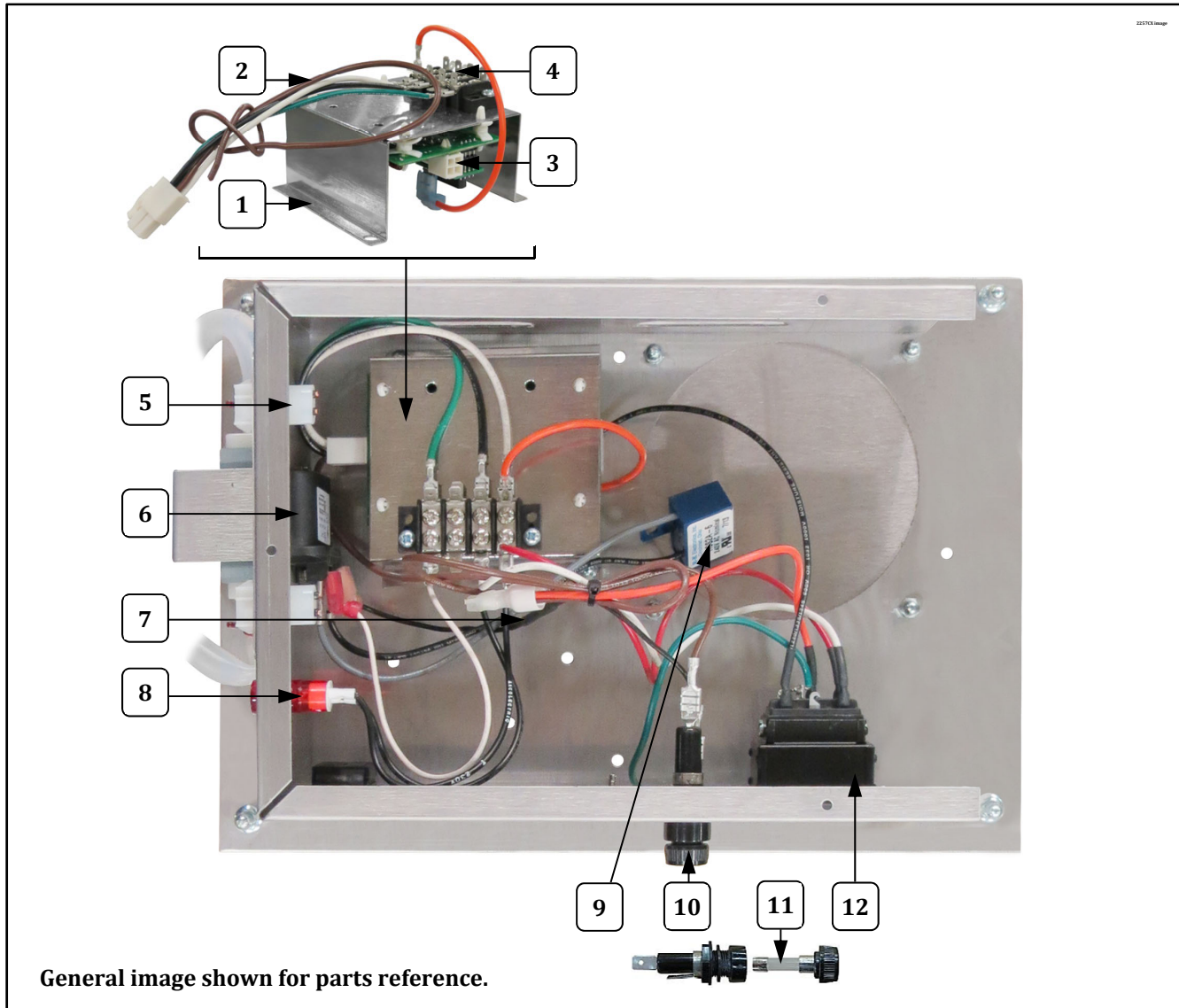

Item	Part Description	Part Number	
		2257C	2257CX
1	MOUNTING BRACKET	79428	79428
2	TEACH ME TIMER WIRE HARNESS	48732B	48732B
3	TEACH ME TIMER (Programmable Timer)	48732	48732
4	TERMINAL BLOCK	45098	45098
5	PANEL MOUNT WIRE ASSY (hole plug only)	39470	39470
6	B.I.B. OIL PUMP	79282	79282EX
7	BIB PUMP BLK DIODE WIRE	79888D	79888D
8	PILOT LIGHT-125V RED	41033	41032
9	240 VAC TRANSIENT FILTER	89087	89087
10	FUSE HOLDER	74636	74636
11	1 AMP FUSE (located inside Fuse Holder)	79341	79341
12	JONES PLUG ASSY	67900	67900





# Model No. 2257CX

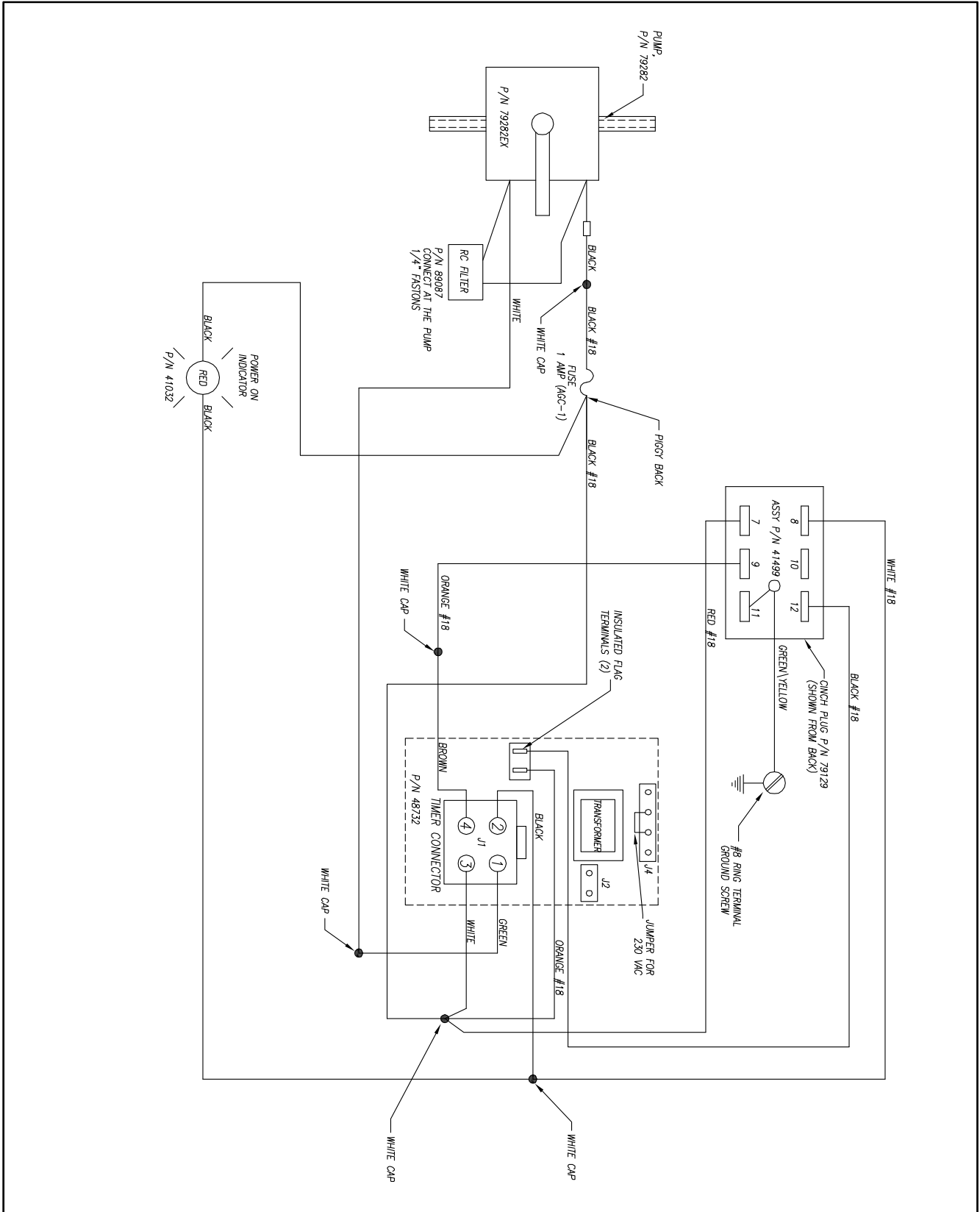



## WARRANTY

Gold Medal Products Co. warrants to the original purchaser each item of its manufacture to be free of defects in workmanship and material under normal use and service. Gold Medal Products Co.'s obligation under this warranty is limited solely to repairing or replacing parts, f.o.b. Cincinnati, Ohio, which in its judgment are defective in workmanship or material and which are returned, freight prepaid, to its Cincinnati, Ohio factory or other designated point. Except for "Perishable Parts" on specific machines, the above warranty applies for a period of two (2) years from the date of original sale to the original purchaser of equipment when recommended operating instructions and maintenance procedures have been followed. These are packed with the machine. Parts warranty is two (2) years, labor is six (6) months.

THIS WARRANTY IS IN LIEU OF ALL OTHER WARRANTIES EXPRESSED OR IMPLIED, AND OF ALL OTHER OBLIGATIONS OR LIABILITIES ON OUR PART, INCLUDING THE IMPLIED WARRANTY OF MERCHANTABILITY. THERE ARE NO WARRANTIES WHICH EXTEND BEYOND THE DESCRIPTION ON THE FACE HEREOF. In no event shall Gold Medal Products Co. be liable for special, incidental or consequential damages. No claim under this warranty will be honored if the equipment covered has been misused, neglected, damaged in transit, or has been tampered with or changed in any way. No claim under this warranty shall be honored in the event that components in the unit at the time of the claim were not supplied or approved by Gold Medal Products Co. This warranty is effective only when electrical items have been properly attached to city utility lines only at proper voltages. This warranty is not transferable without the written consent of Gold Medal Products Co.

The term "Original Purchaser" as used in this warranty shall be deemed to mean that person, firm, association, or corporation who was billed by the GOLD MEDAL PRODUCTS CO., or their authorized distributor for the equipment.

THIS WARRANTY HAS NO EFFECT AND IS VOID UNLESS THE ORIGINAL PURCHASER FIRST CALLS GOLD MEDAL PRODUCTS CO. AT 1-800-543-0862 TO DISCUSS WITH OUR SERVICE REPRESENTATIVE THE EQUIPMENT PROBLEM, AND, IF NECESSARY, FOR INSTRUCTIONS CONCERNING THE REPAIR OR REPLACEMENT OF PARTS.

*NOTE: This equipment is manufactured and sold for commercial use only.*



**GOLD MEDAL<sup>®</sup> PRODUCTS CO.**

10700 Medallion Drive, Cincinnati, Ohio 45241-4807 USA

[gmppopcorn.com](http://gmppopcorn.com)

Phone: (800) 543-0862      Fax: (800) 542-1496  
(513) 769-7676              (513) 769-8500